

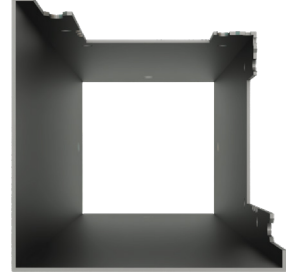

COMPACT

Maximum Width
4500 MM
Maximum Opening
8000 MM



1-PILLAR



2- RAIN GUTTER



3- PANEL



4- PISTON

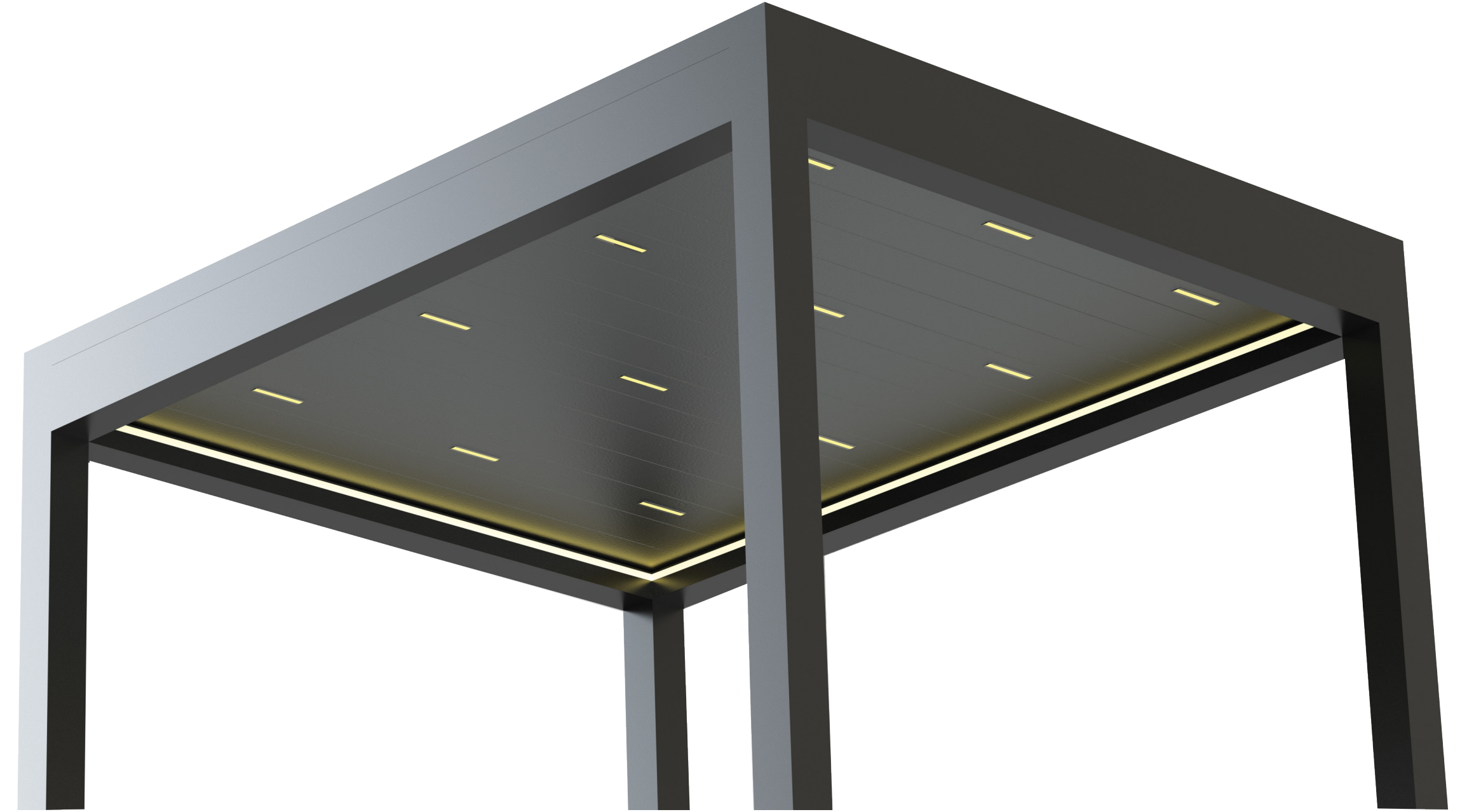

Same Environment
different feelings





110° ROTATION

During the season transitions as of the hidden stream in the panel design
It is ensured that water, dust, burrs, leaves and all particles doesn't fall down.

It has an integrated panel design that gives a monolithic appearance.

Polyurethane foam prevents condensation with
the filling option.

It also helps with thermal insulation.

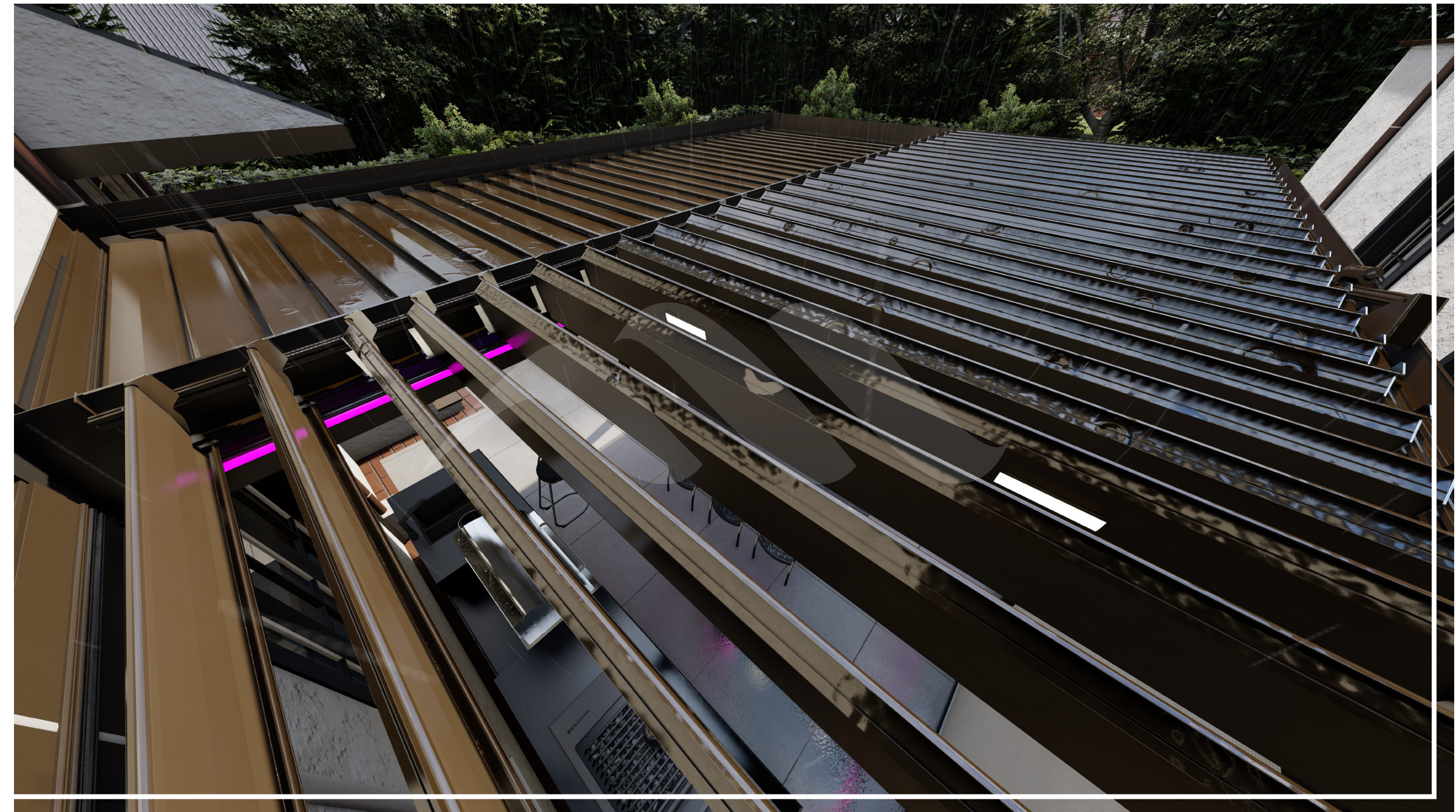



the groove joint apparatus specially is designed
for multiple modules installed next to each other,
water decontamination between modules
can be provided, as well as,
two systems that can carry with a single pillar profile.

RAL CATALOG

7012	7015	7016	7021
7022	7037	7039	7040
7047	8003	8011	8012
8014	8015	8016	8017
9001	9002	9010	9011



Motor, LED Driver Board, and Remote Control

- The driver board designed by ROYALCLASS serves to both protect and control the motor and LEDs of the Compact system.
- It provides the capability to control the LEDs and motors of 6 systems with just one remote control.
- In situations where external factors that could affect the system's motor are encountered, the driver board safeguards the motor by shutting itself down.
- The remote control features RGB color-changing and dimmer functionality.



www.royalclasstente.com

+90 850 480 8265